

**EUROMECH**  
ENGINEERING EXCELLENCE

## Shelving

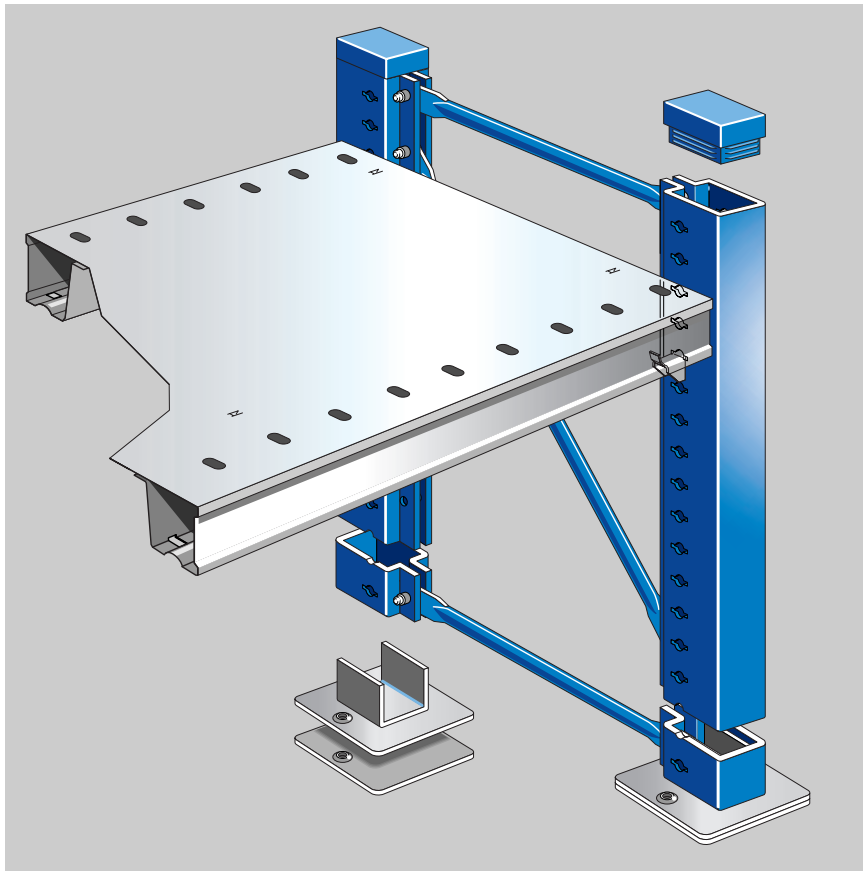

**Shelving** is available in many configurations in either low or high bay, and in multi-tier or mobile systems, for general storage or archive situations. The system is easily adjustable in height in increments of 25 mm and has many accessories to enhance the storage possibilities.

With frame load bearing capacity up to 10,000 kg and installation heights from 2 to 25 metres Nedcon's range of upright profiles allows complete custom-made solutions possible. Uprights are available in one piece up to 14,4 metres long and therefore limits the need for splices.

1



Nedcon **shelves** are available with load-bearing capacities till 600 kg, sendzimir galvanized (impact-resistant powder coat finish on demand). The shelves are produced in a range of lengths. Nedcon shelving is also ideal for high, crane-operated installations, or for high-rise construction in combination with mezzanine floor systems.



1

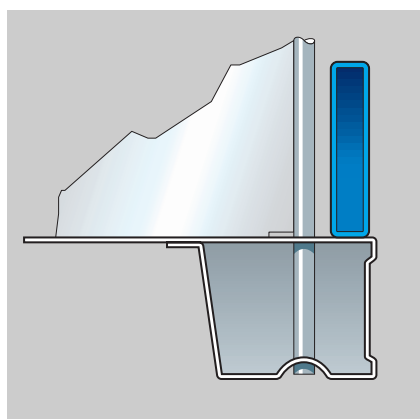
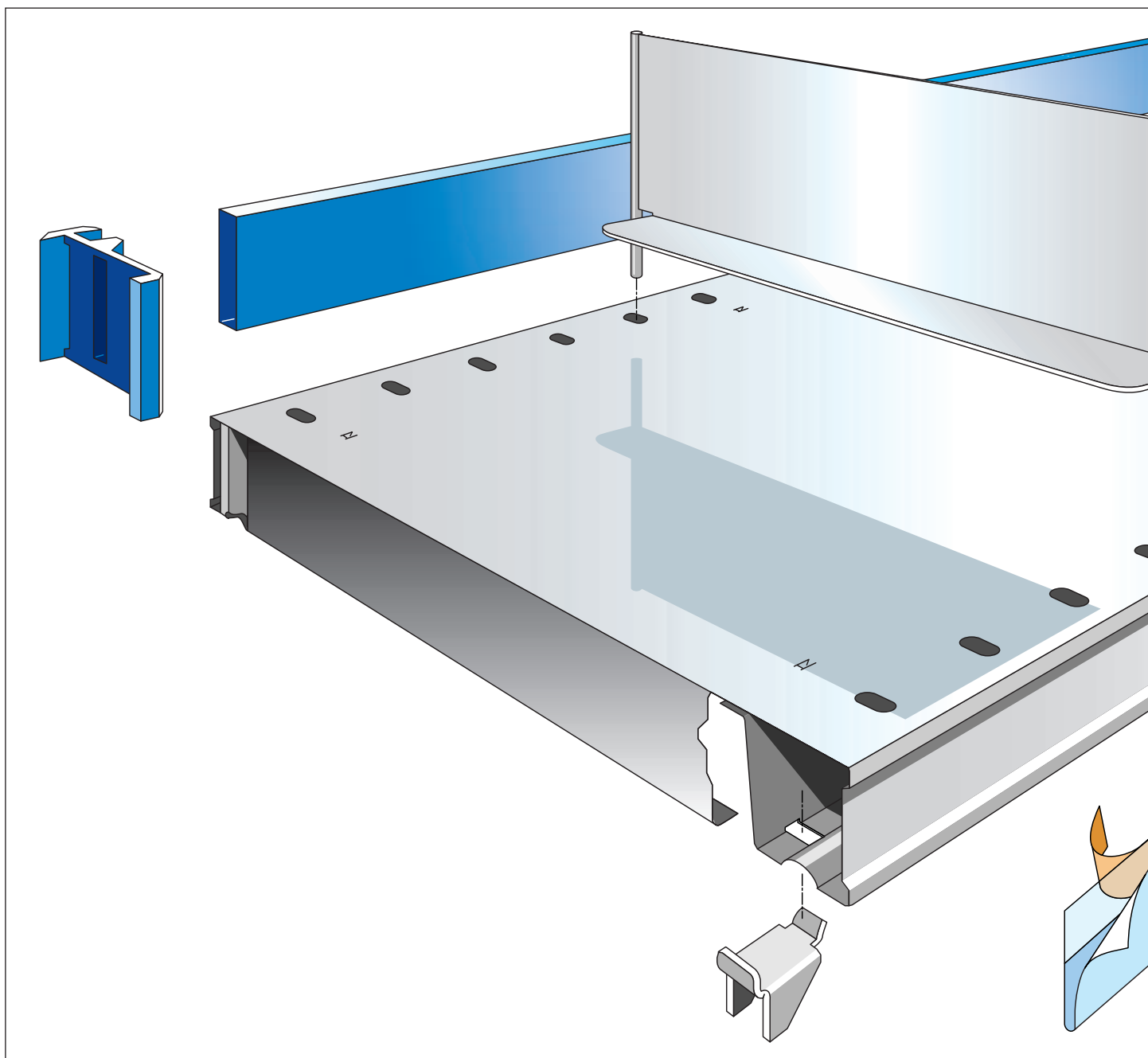

Detail of shelf and divider. The rounded edge of the divider does not protrude below the shelf.

The front plinth also has rounded corners and can be easily fitted with plastic clips.

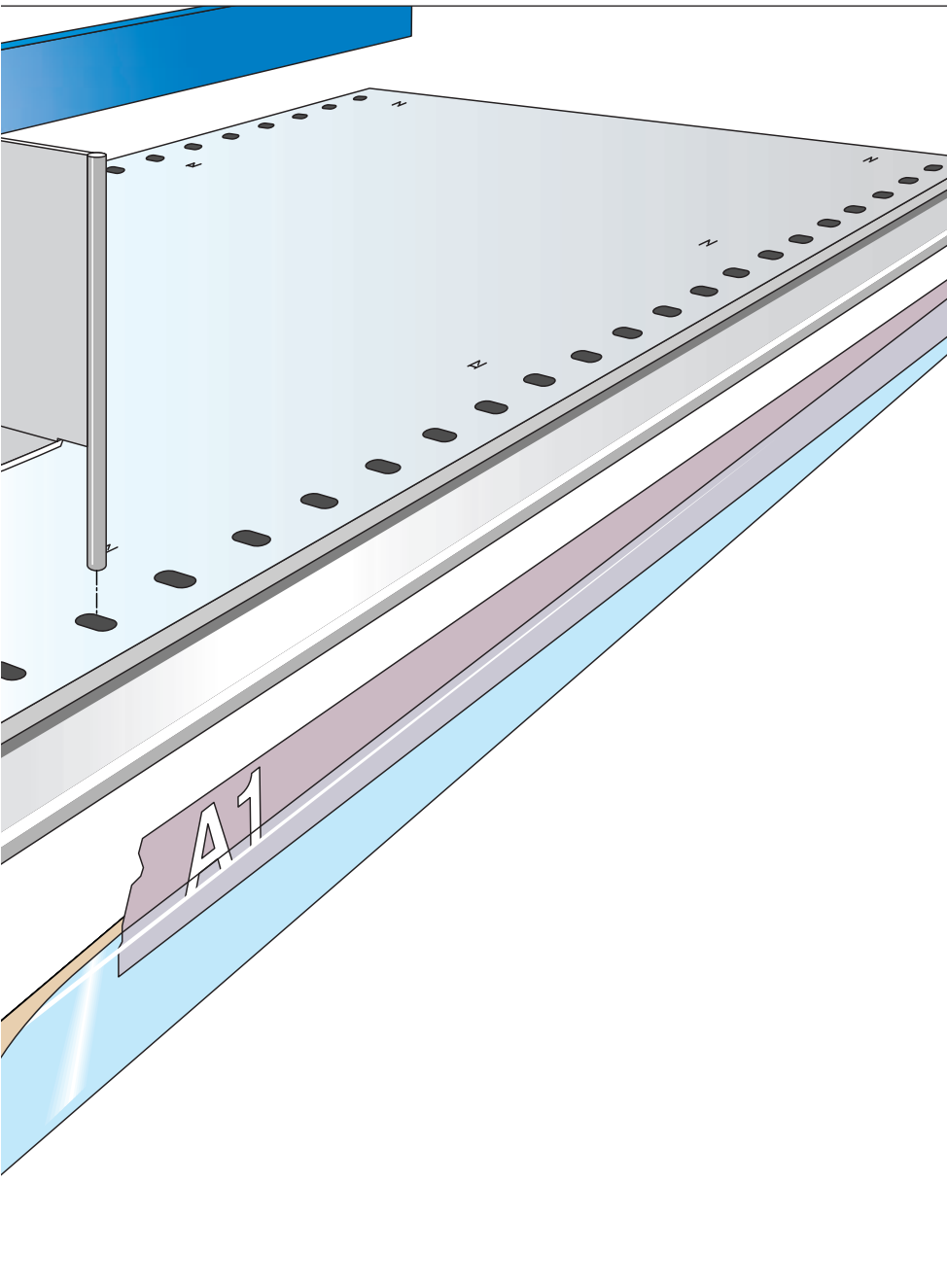
**Nedcon shelf – characteristics:**

- the box-shaped edges will not twist under load, have no sharp edges and are very strong and stiff, due to the profile dimensions and shape
- the short sides are double folded and form a 40 mm high U-profile, which assures all round strength
- the front profile is purpose formed to support magnetic labels and is ideal for fixing all other forms of location labels
- the double material thickness, where the shelves fit on the clips, increases resistance against impact loads

The unique design and construction of the Nedcon shelf gives greater load bearing capacity and less edge bending than traditional shelves.

The location indicators are protected by transparent, self-adhesive label holders and are easy to replace or move.

Shelves are sometimes used to stand on. The strong box-section front increases the resistance to this improper loading.

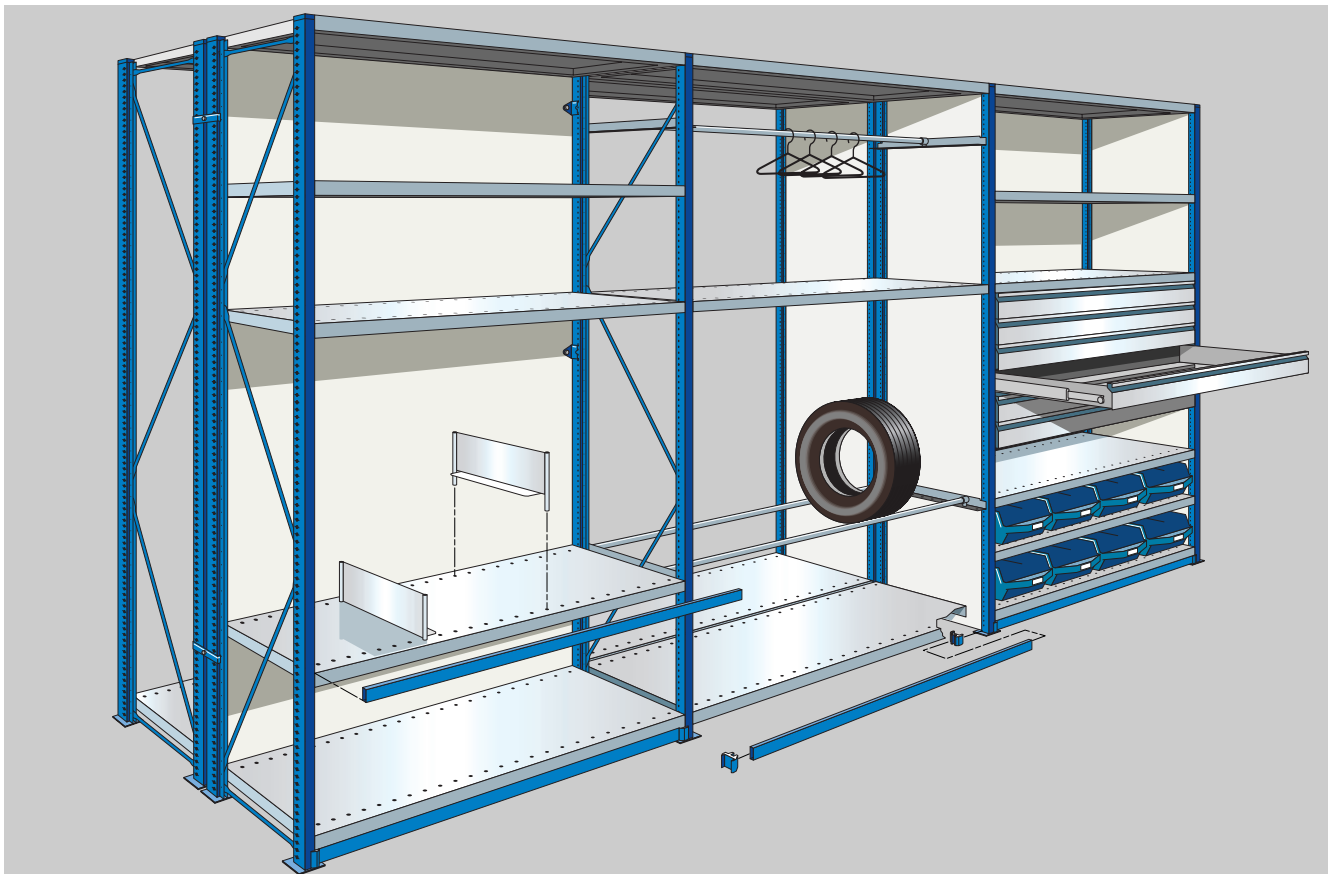

The following supplements are available:

- floor plinths
- front plinths
- dividers with rounded front, which fit in the shelf perforations
- rails for hanging files
- tyre supports
- clothing rods
- steel drawers, with dividers, can be pulled out 100% on telescopic guides
- back and side panels in various materials.



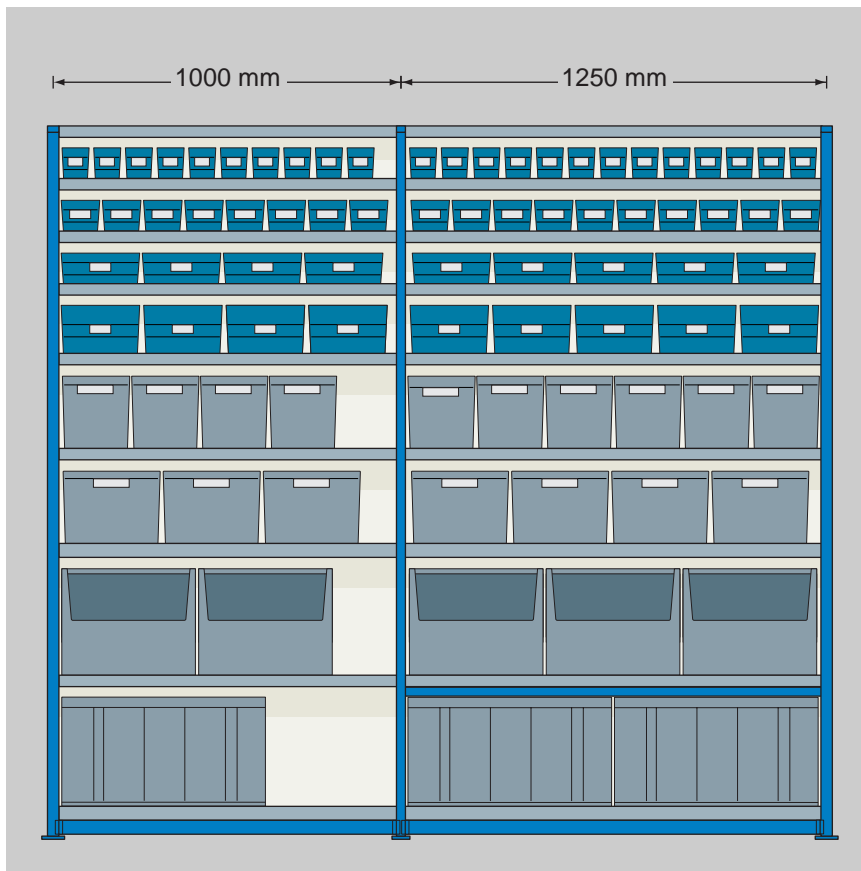

### Bay dimensions

The most common bay length for shelving used to be 1,000 mm. These days, the dimensions of plastic containers and cardboard packaging are increasingly related to the Euro-pallet dimensions (1,200 x 800 mm).

So standard containers and cartons with lengths and widths of 200, 300, 400 and 600 mm fit into 1,250 mm racks without any wasted space. This also applies to the plastic containers shown.

Other bay dimensions are also possible for goods with different dimensions. The maximum bay length with perforated shelving is 1,500 mm, while unperforated shelves can be manufactured in greater lengths, as required.

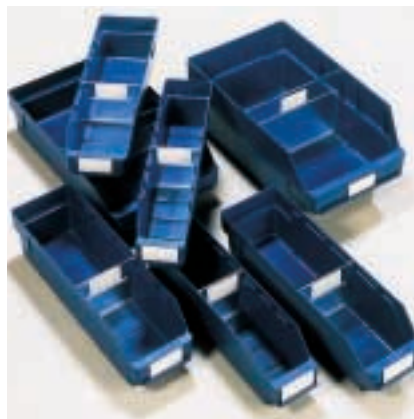

**Plastic containers** with dividers and labels for shelf depths of 300, 400 and 500 mm; colour is blue, identical to the upright frames.

Widths: 90, 118 and 236 mm. Heights: 90 and 150 mm.



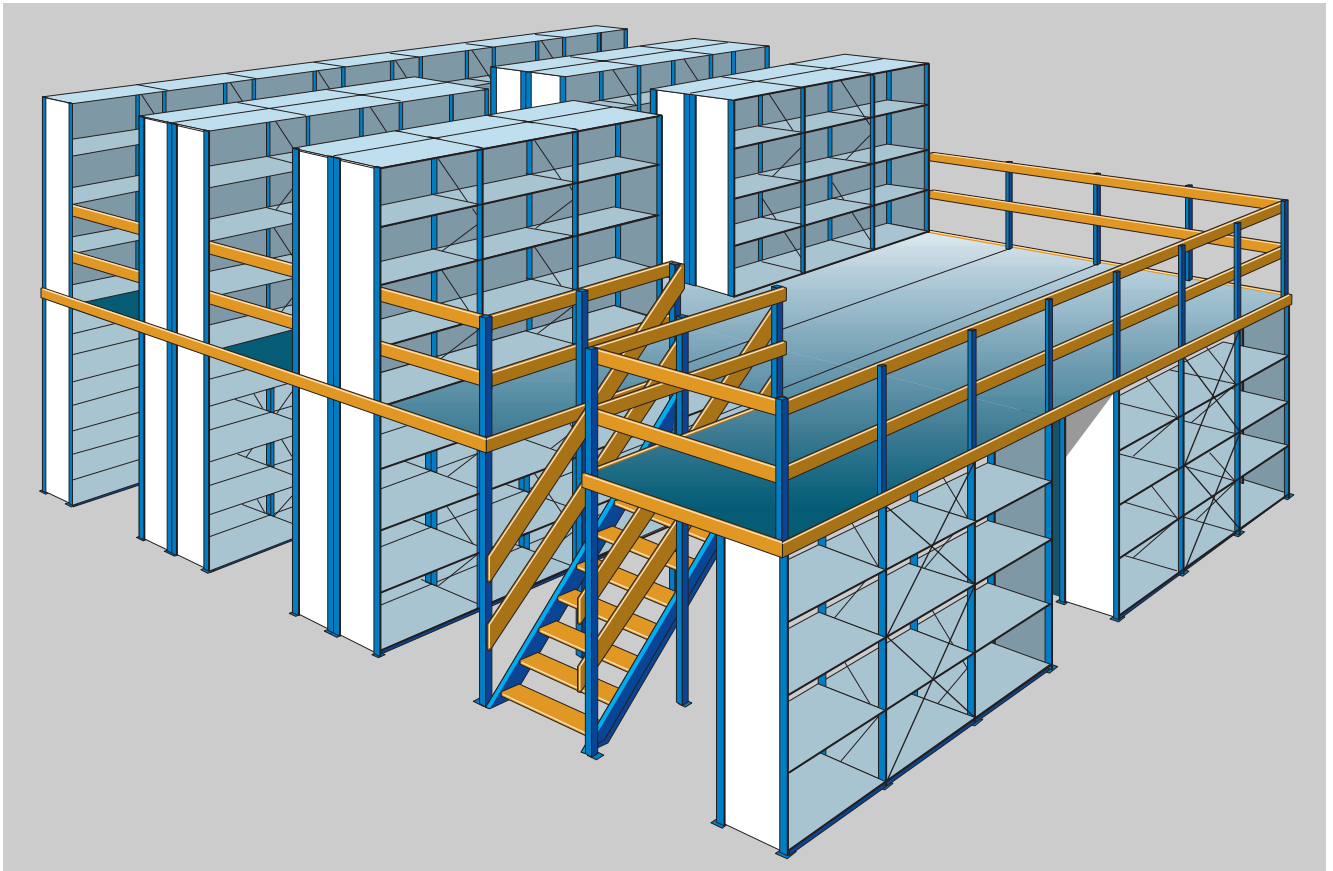

**Multi-tier construction** can be stack-constructed with separate overall floors, or with continuous uprights and intermediate floors.

Floors can be either solid panels or open grating. Panel floors are more common as operating noise can be reduced, pallet trucks can be used and there is no risk of dust or other debris falling through.

Panel floors are available in different strength qualities (bending strength from 10 to 22 N/mm<sup>2</sup>) and in various thicknesses (28 to 60 mm). Nedcon has developed a heavy-duty floor panel with sandwich construction, which withstands very high concentrated wheel loads from electric pallet trucks.

Floor panels are fitted together with tongue-and-groove joints, where the joint is not supported by the steel construction. The panel surface can be finished with a decorative wear-resistant layer (abrasion-resistance class S1, in accordance with DIN 68765-1987). The underside of the panels can be finished with a white melamine layer for light reflection.

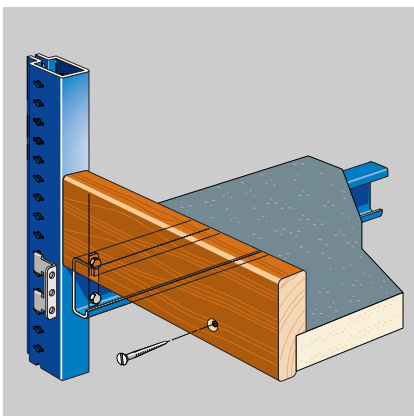

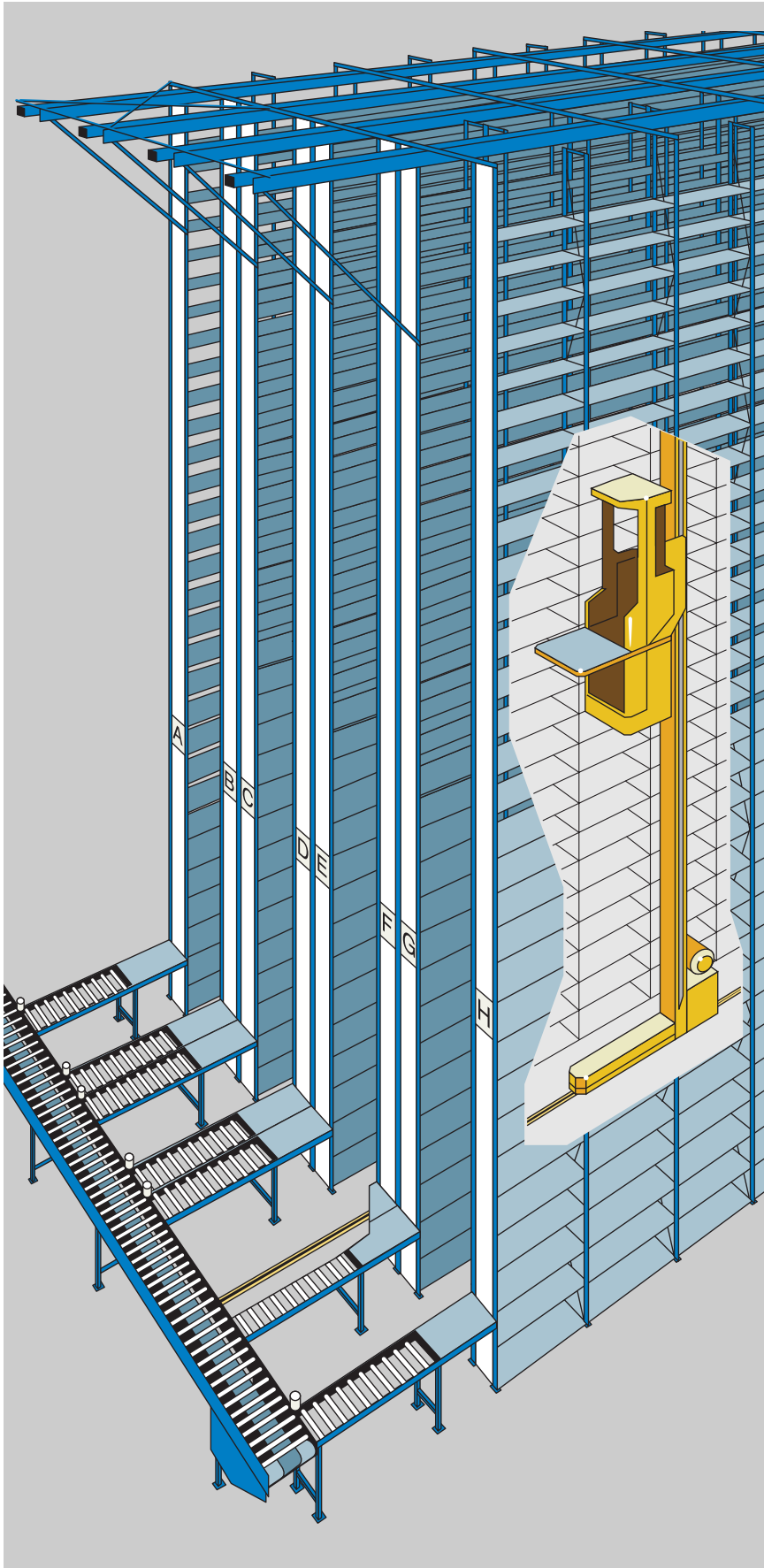

**High-rise shelving racks** are serviced by cranes and are characterised by the stringent requirements laid down for tolerances and stability.

Perfectly vertical positioning, levelling, anchoring and grouting are vital in automated systems for accurate crane positioning.

With high, shallow depth racks the load-bearing capacity of the frames plays an even more important roll due to the frame slenderness.

Upright profiles must be perforated over their whole length with exceptional precision.

Precision assembly of the top guide rails is essential for vibration-free operation. Any sprinkler system must be incorporated in the design.

Nedcon has considerable knowledge and experience of this type of high shelving construction.

1



Storage systems for small parts